

25

SunTera 50MW/100MW
55MWh

SunTera
3.44 MWhs

SunTera
2.5



JKE-

H-LAA

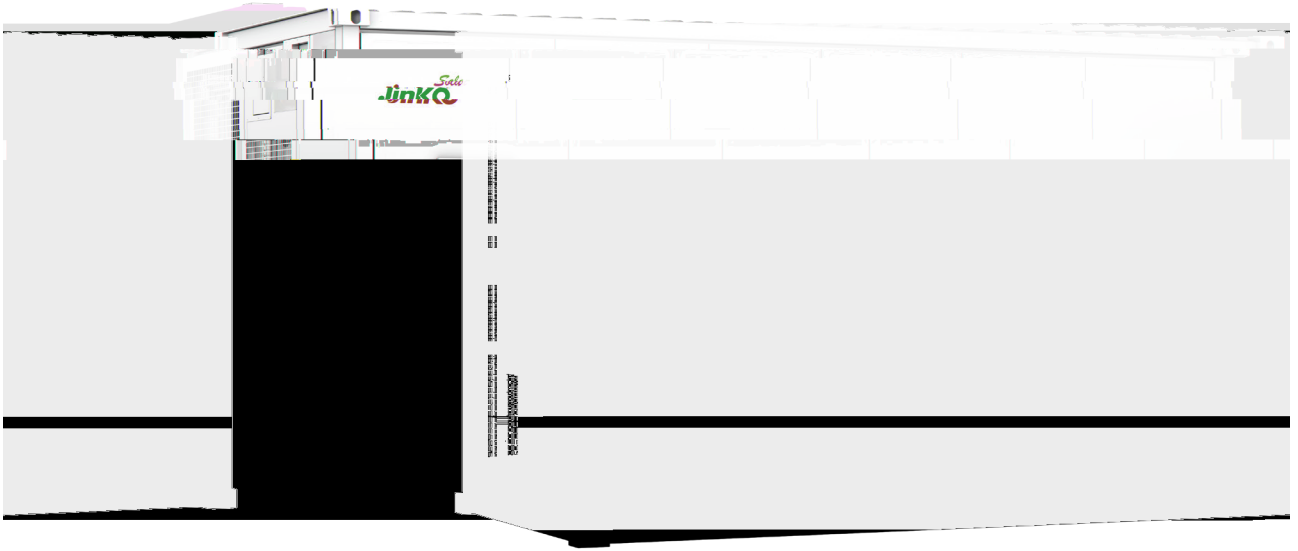

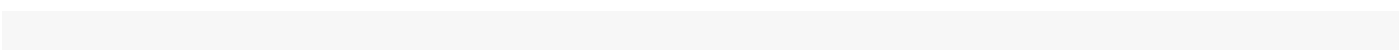
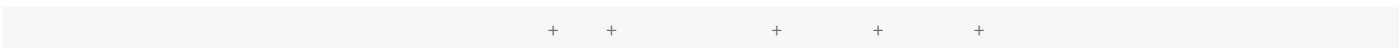
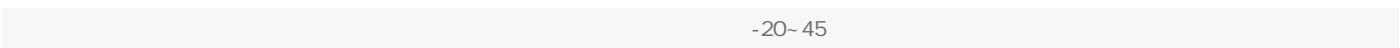
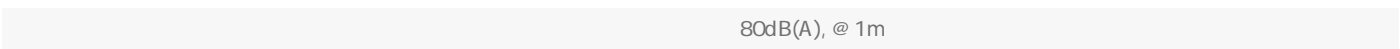
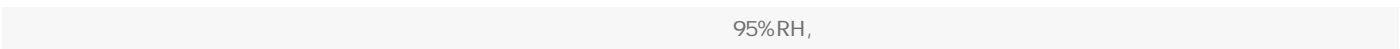
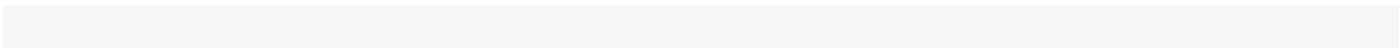
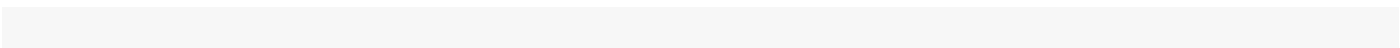
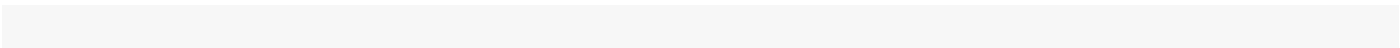
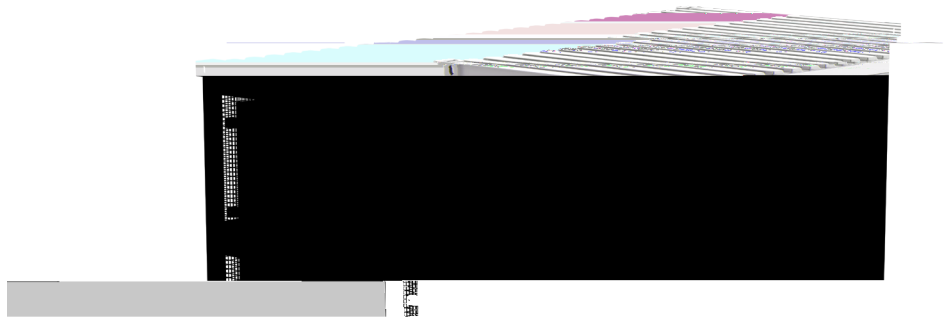

-20- 50

95%RH,

2000m / < 4000m (,)

80dB(A), @ 1m

IP

-20- 45

C3 (EN ISO 12944) / C4 () / C5()

+ + + + +

net/Fiber ()

(L×W×H)

6058× 2438× 2896mm

35000